

# Monidrop® W Infusion monitor, Quick guide

The Monidrop infusion monitor is intended for measuring IV fluid administration in infusion therapy. The device displays the infusion rate, total volume administered and treatment duration, and makes it possible to set alarm limits.



**Monidrop DOES NOT ADJUST the infusion rate. ALWAYS use a roller clamp to adjust the infusion rate. Do not fully open the roller clamp.**

## 1. Starting and using Monidrop device



a) Start the device by pressing the power button. 

b) Attach Monidrop to the drip chamber (see instruction in section 2). Adjust the desired infusion rate with the roller clamp.

Shut down the device by pressing the power button  for three (3) seconds. When the device is switched off, any previously set data and settings will be reset.

Monidrop displays the infusion time, infusion rate (ml/h) set and the volume of fluid (ml) administered during therapy.

## 2. Attaching Monidrop to the drip chamber

a. Open the device retaining clip by pressing the locking lever and pulling the clip to release.

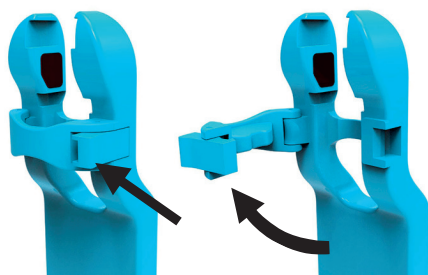

b. Position the drip chamber appropriately. Note the correct positioning of different types of drip chambers.

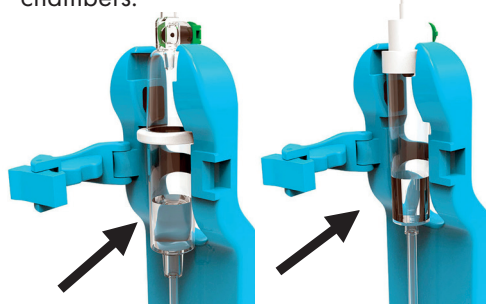

c. Turn the retaining clip to its original position until it clicks.

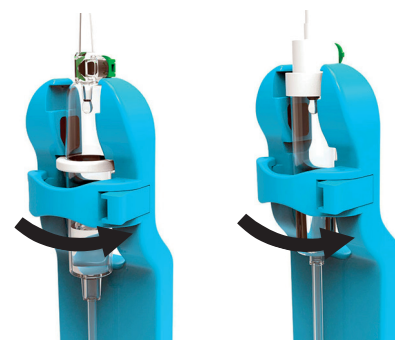



## 3. Adjusting the infusion rate and monitoring the therapy

Adjust the infusion rate by means of the roller clamp on the infusion set to the appropriate precision. A green LED light and a drop icon on the screen indicate that IV administration is ongoing.



## 4. Managing audio notifications

a. Audio notifications can be muted and activated using the notification button.  At the top of the screen, the mute symbol is displayed when the message is less than 6ml / h.  Notifications with an infusion rate less than 6 ml/h are always muted by default when the device is turned on.

b. By pressing the audio notification button a second time, the battery charge status notification sound is also muted. Pressing the button again will enable audible notifications for battery status and infusion rate less than 6 ml / h.

## 5. Screen view

During treatment, the rate and total volume of infusion can be monitored on the device screen. The functions are explained below.

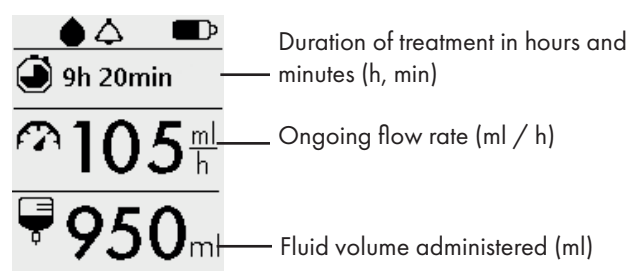

FI Lue lisätietoja laitteen käytöstä ja ominaisuuksista lataamalla Monidrop® W käyttöohje osoitteesta [www.monidor.com](http://www.monidor.com)

EN For additional information on the use and features of the device, the Monidrop® W user manual can be downloaded from [www.monidor.com](http://www.monidor.com)

SV Mer information om mätarens funktioner och hur den används, Monidrop® användarhandboken kan hämtas från [www.monidor.com](http://www.monidor.com)

DE Für weitere Informationen über die Verwendung und Funktionen des Geräts kann die Monidrop®-Bedienungsanleitung von [www.monidor.com](http://www.monidor.com) heruntergeladen werden

NL Download de handleiding van de Monidrop® voor meer informatie over het gebruik en de mogelijkheden van het apparaat. De handleiding vindt u op [www.monidor.com](http://www.monidor.com)

DA Yderligere oplysninger om brugen af enheden og dennes funktioner fremgår af brugervejledningen, der kan downloades fra [www.monidor.com](http://www.monidor.com)

FR Pour plus d'informations sur l'utilisation et les fonctionnalités de l'appareil, veuillez vous reporter au manuel d'utilisation de Monidrop® sur [www.monidor.com](http://www.monidor.com)

#### **Important charger safety instructions:**

This product is intended for indoor use only. When using an electrical appliance, basic safety precautions should always be followed, including the following: Read all instructions before using power supplies.

**DANGER** - To reduce the risk on electric shock: A power supply should never be left unattended when plugged in. Always unplug this power supply from the electric outlet immediately after using.

**WARNING** - To reduce the risk of burns, fire, electric shock, or injury to persons:

1. Do not allow to be used as a toy. Pay close attention when this power supply is used by or near children.
2. Use this power supply only for its intended use as described in this manual. Use only attachments recommended by the manufacturer as contained in this manual.
3. Never operate this power supply if it has a damaged cord or plug, if it is not working properly, if it has been dropped or damaged, or fallen into water. In such cases, return the appliance to the nearest authorized dealer or service center for examination, repair, electrical or mechanical adjustment.
4. Never drop or insert any object into any openings.
5. Do not use outdoors.
6. Do not operate where aerosol (spray) products are being used or where oxygen is being administered.
7. The socket-outlet should be installed near the power supply and should be easily accessible.
8. Do not unplug by pulling on cord. To unplug, pull on the plug, not on the cord.
9. Units without level V Efficiency may no longer be used for electronic household and office equipment.
10. Manufacturer can be contacted: Sinpro Electornics Co.,Ltd. No.5, Yanxi St. P.E.P.Z. Pingtung City, Pingtung County 90093, Taiwan